

### Vista Life residential complex

LocationKyrenia, Çatalköy



#### Complex infrastructure

- Central heating System
- Central satellite
- Open pool
- Parking
- Security Camera System
- VRF system

### About the project



Developer	Ardem	
Start of sale	01.10.2022	
Key handover	2024	
Houses/blocks	4	
Building floor	2 Min	2 Max
Units total	16 - 1+1	

Distance to the sea - 1200 m

Distance to key locations:

Airport 30 min. Supermarket 1 min. Pharmacy 10 min. School 2 min. Kindergarten 2 min. Hospital 8 min.

The Vista Life project is located in the Catalköy area of Kyrenia. This is a project designed with elements of modern and classical architecture. If you want to be close to the beaches, close to the center of Kyrenia, live surrounded by nature with views of the mountains and the sea, choose the Vista Life project... The Vista Life project consists of 4 blocks, with a total of 16 residences.

### Available units4 / 16 total

#### Median price per unit, K GBP

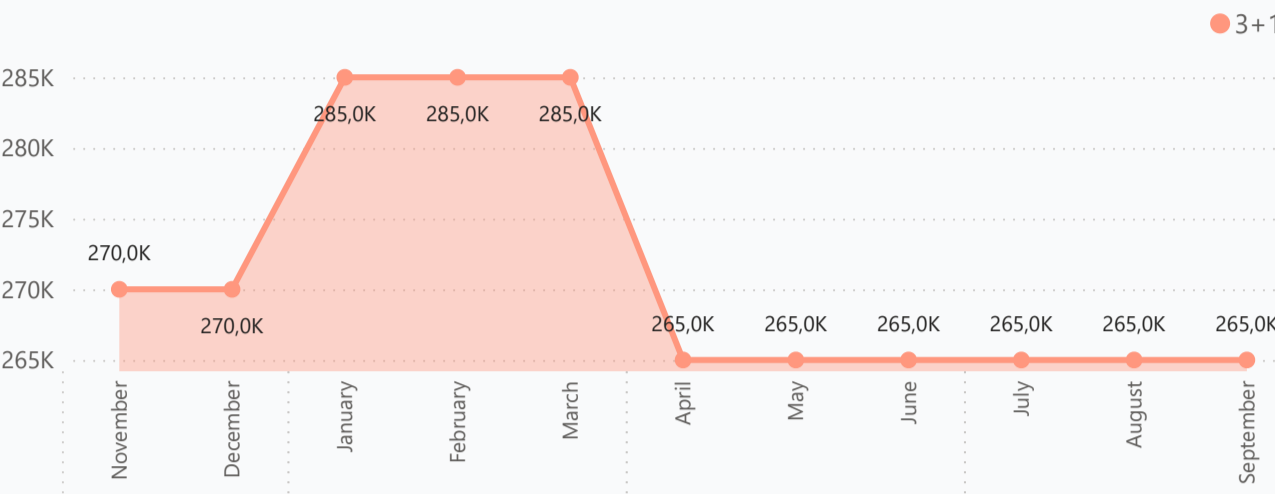

#### Structure of available units

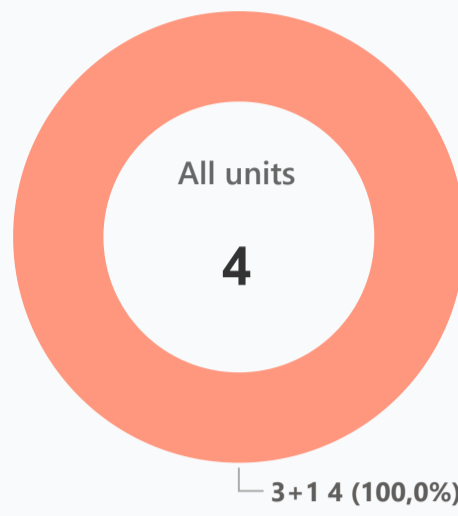

### Plans



3+1

### Payment plans

#### Deposit (non-refundable) -

Option 1 Down payment 35 % Installments months 35% till key, 30%... Discount - Offer -	Option 2 Down payment - Installments months - Discount - Offer -	Option 3 Down payment - Installments months - Discount - Offer -	Option 4 Down payment - Installments months - Discount - Offer -
--	--	--	--

### Special offer



Fully furnished design package

Rental guarantee

### Details

Bedrooms	Subtype	Block	Unit №	Floor	View	Bathroom	Internal area, sq. m	Balcony/ Terrace, sq. m	Rooftop terrace, sq. m	Garden, sq. m	Gross covered area, sq. m	Current price, GBP	Price per sqm, GBP
3+1	Flat	A2	2	0				13		143	130	225 000	1 731
3+1	Flat	A3	1	0				19		190	136	245 000	1 801
3+1	Flat	B1	1	0				41		80	158	285 000	1 804
3+1	Flat	B1	3	01				18	128		264	285 000	1 080

### Interior specification

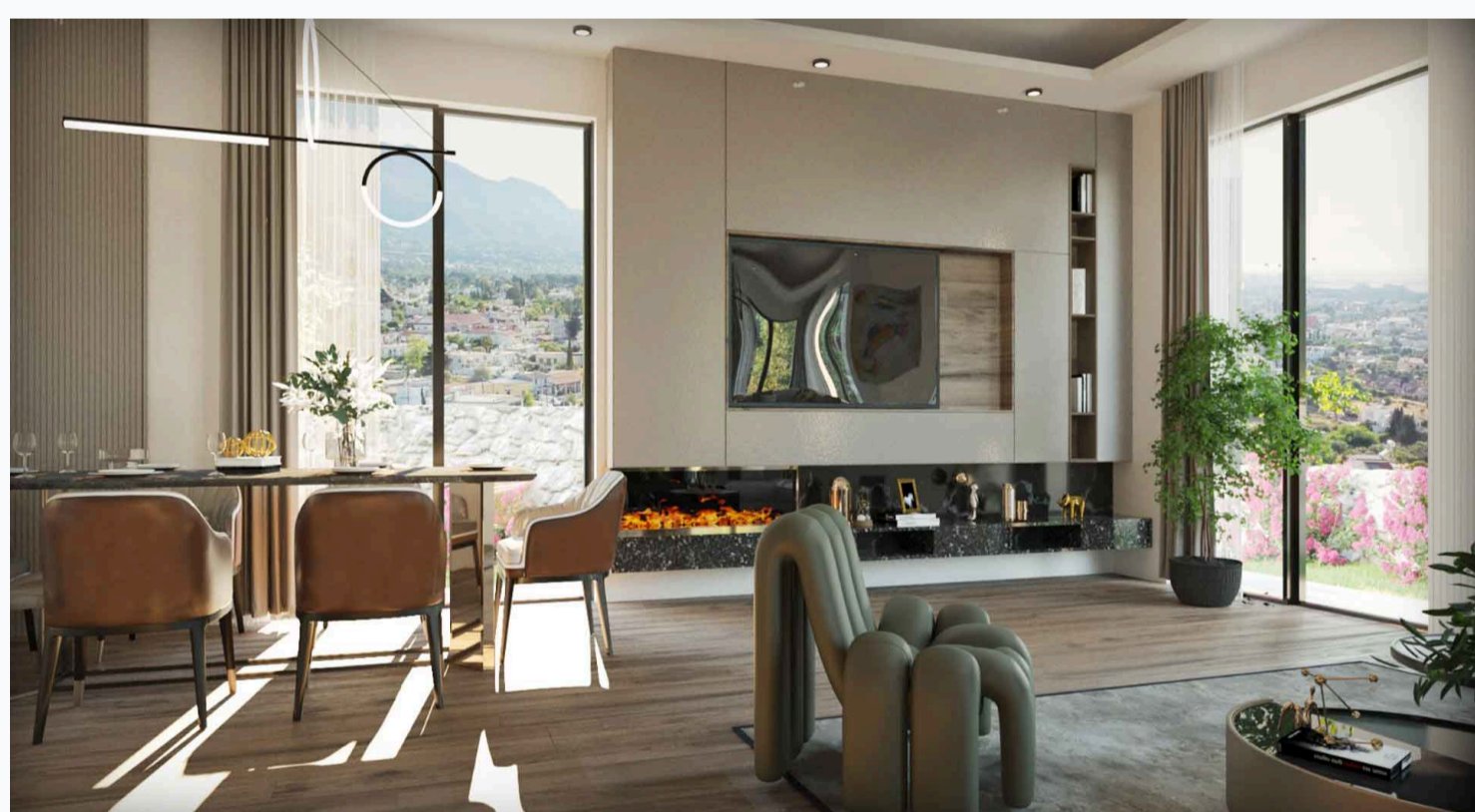

#### Interior specification

- Ceramic flooring
- Double glazed windows
- Laminate flooring in the bedrooms

### Exterior specification

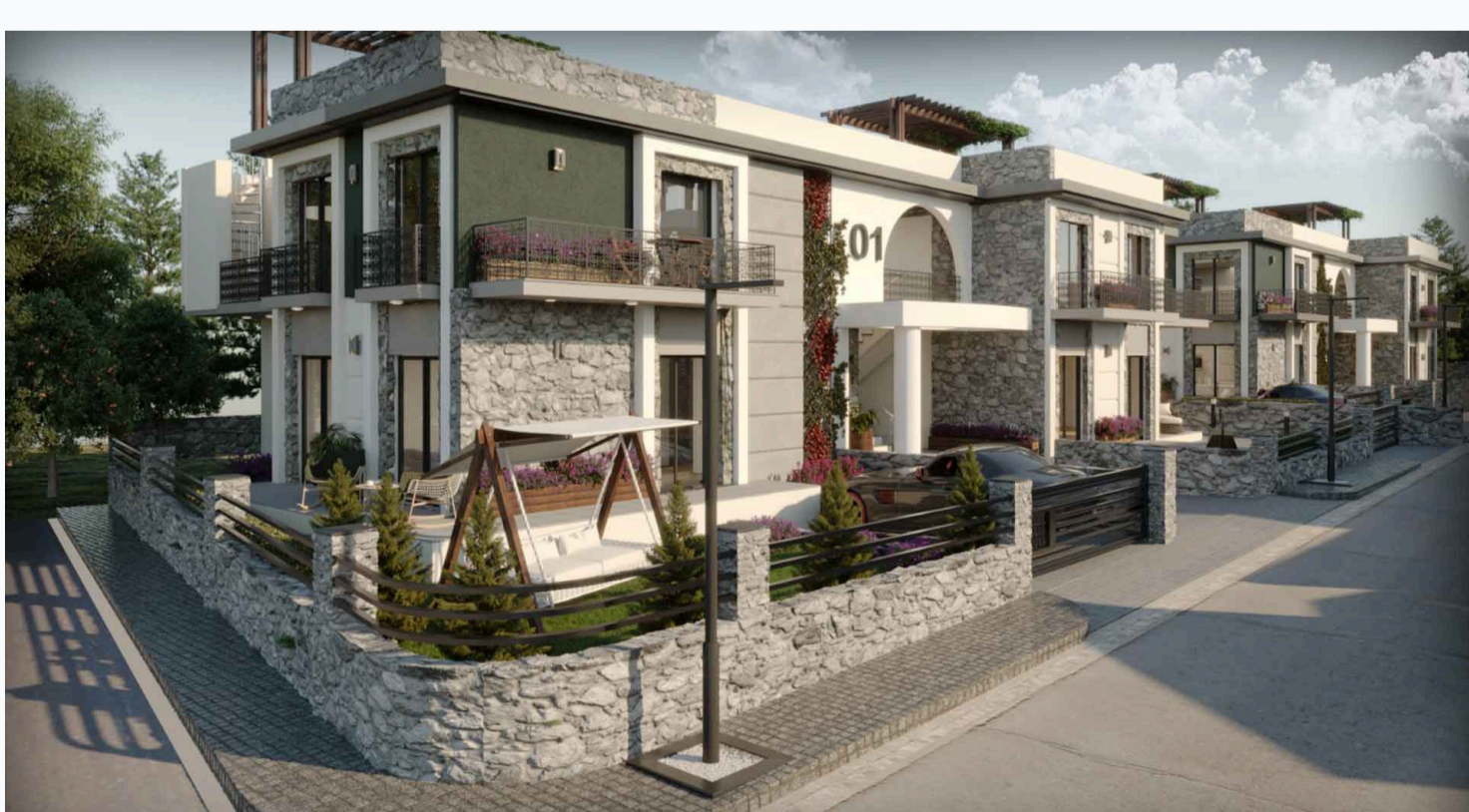
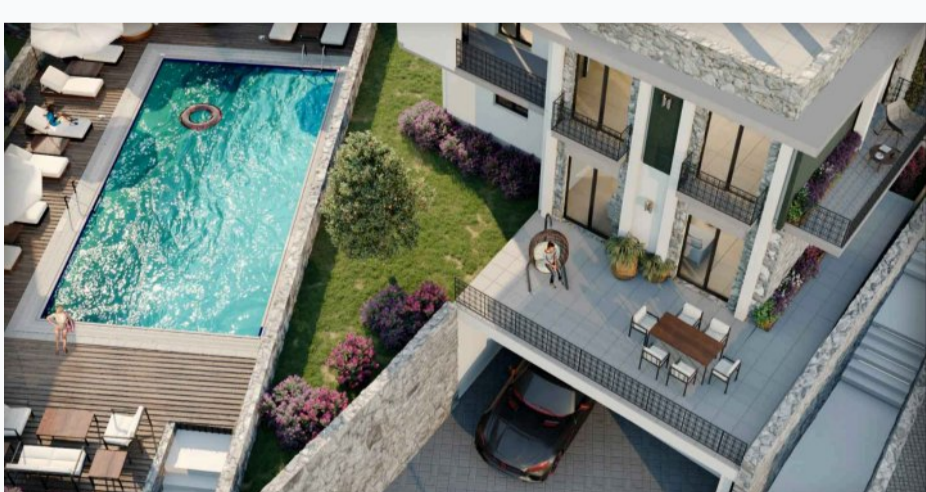

#### Exterior specification

- Private Garden
- Terracing witu, inbuilt lighting & power sockets

### Location of complex

